

ASCENDA SIZE "L" ELEVATOR SPECIFICATIONS

GENERAL:

- TRAVEL: xxx
- OVERHEAD: xxx
- SPEED: 30 FPM
- LOAD CAPACITY: 770 lbs
- STOPS: TWO
- SINGLE OPENING (FRONT)

CAR FEATURES:

- 27 $\frac{9}{16}$ " W X 39 $\frac{3}{8}$ " D CAR SIZE
- 78 $\frac{11}{16}$ " INTERIOR CAR HEIGHT
- WHITE/BLACK TEXTURE POWDER COATED CAB WITH CLEAR LAMINATED SAFETY GLASS VISION PANELS
- 2 HANDRAILS (W/INTEGRATED CONTROLS)
- BLACK CAR ACCENT STRIP
- CHARCOAL FORGO FLOORING
- (4) ENERGY SAVING RECESSED LED LIGHT WITH SILVER TRIM RINGS
- (1) 78 $\frac{5}{16}$ " CLEAR LAMINATED SAFETY GLASS SALOON DOORS
- FLIP DOWN SEAT

FIXTURES:

- BLACK ACRYLIC CAR OPERATING PANEL (COP) WITH WITH INTEGRATED KEYPAD PHONE AND STATUS DISPLAY, UP/DOWN ARROW BUTTONS, AND ALARM BUTTON
- SILVER ALUMINUM HANDRAIL WITH CONTROLS, UP/DOWN ARROW BUTTONS, DOOR OPEN BUTTON, IN CAR EMERGENCY STOP BUTTON AND FAN KNOB
- (2) WIRELESS HALL STATIONS WITH UP/DOWN ARROW BUTTONS AND DOOR OPEN BUTTON

MECHANICAL EQUIPMENT:

- MODULAR EXTRUDED ALUMINUM RAIL STRUCTURE
- CAR FRAME ASSEMBLY
- 230 VAC, 60Hz, 30 AMP SINGLE PHASE POWER SUPPLY
- 24 MM PITCH SCREW DRIVE SYSTEM
- INTEGRATED FREQUENCY INVERTER DRIVE SYNCHRONOUS MOTOR

ELECTRICAL:

- MAIN LINE: 230 V, 60Hz, , 30 A, SINGLE PHASE
- CAR LIGHT (OPTIONAL): 115 V, 60Hz, 15 A, SINGLE PHASE

SAFETY DEVICES:

- SAFETY NUT
- BELT MONITOR
- ONE UPPER AND ONE LOWER FINAL LIMITS
- IN-CAR EMERGENCY STOP SWITCH AND ALARM
- CAR DOOR LOCKING DEVICE FOR CAR GATE(S)
- BATTERY BACK UP EMERGENCY CAR LIGHT AND ALARM
- TOP CAR OBSTRUCTION SAFETY DEVICE
- BOTTOM CAR OBSTRUCTION SAFETY DEVICE
- HATCH OBSTRUCTION SAFETY DEVICE
- BATTERY LOWERING SYSTEM
- OVERLOAD SENSOR
- MANUAL LOWERING DEVICE

CONTROLS:

- CONSTANT PRESSURE OPERATION
- SELF DIAGNOSTIC SYSTEM WITH DIAGNOSTIC LED

OPTIONAL INCLUDED FEATURES:

- IoT MODULE - WI-FI AND SIM CARD
- EMBEDDED TOWER LED LIGHT STRIP
- INTEGRATED FAN
- MIRROR FINISH CEILING
- CONTROL BUTTONS - DUAL COLOR
- ACCENT CAR PANEL WITH RECESSED LIGHT
- CONTROL BOX LOCATION: A SIDE/C SIDE/REMOTE (2 BENDS MAXIMUM)

CIBES SYMMETRY

TITLE ASCENDA TFL-L			SCALE NONE
DRAWN BY DRAWN_BY	DATE DRAWN_DATE	DRAWING NO. DRAWING_NO	REV REV_NO
JOB INFORMATION JOB_REFERENCE JOB_ADDRESS JOB_CITY_ST_ZIP			

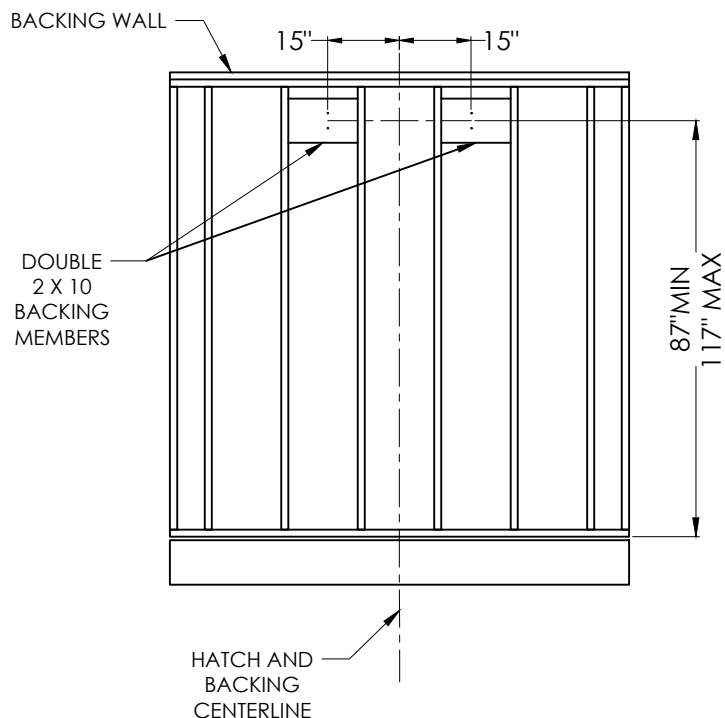
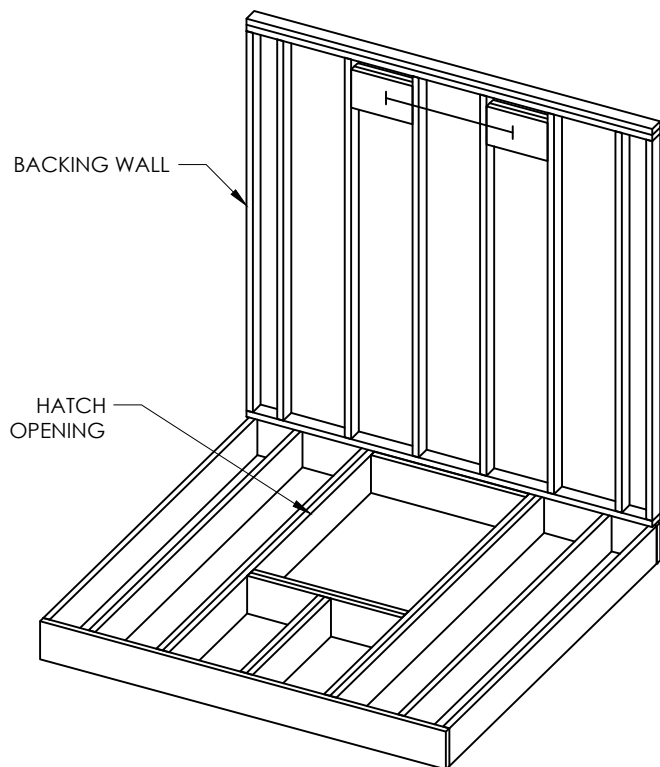

BACKING NOTES:

1. WALLS TALLER THAN 8' REQUIRE DOUBLED 2X4 STUDS OR 2X6 WALL CONSTRUCTION
2. USE GLUE OR CONSTRUCTION ADHESIVE ON ALL JOINED SURFACES
3. USE #8 X 2.5" WOOD SCREWS FOR THE 2 X 4'S
4. USE #10 X 3" WOOD SCREWS FOR THE 2 X 10'S

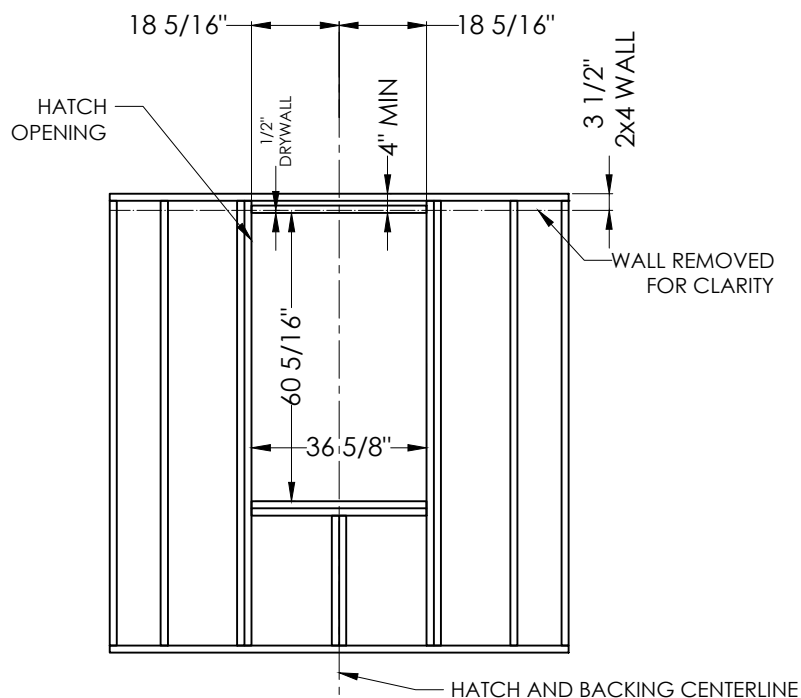

HATCH NOTES:

1. 3/4" SUBFLOOR AND 2X4 WALL REMOVED FOR CLARITY
2. JOIST HANGERS AS REQUIRED BY LOCAL BUILDING CODE
3. INSIDE SURFACE OF THE HATCH TO BE SOLID UNFINISHED MATERIAL
4. CUT SUBFLOORING FLUSH TO HATCH OPENING
5. ENSURE HATCH OPENING IS AT LEAST DRYWALL THICKNESS AWAY FROM STUD WALL ON BACKING WALL SIDE.
6. ENSURE HATCH OPENING IS AT LEAST 2 3/16" AWAY FROM WALL MOUNTED PROTRUSIONS OR WINDOW SILLS, CURTAINS ON OTHER THREE SIDES.

BACKING MEMBER CONSTRUCTION DETAILS

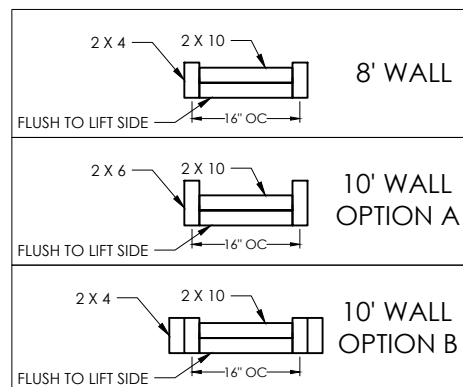

CIBES SYMMETRY

TITLE TFL-L ASCENDA BACKING DETAIL R3			SCALE NONE
DRAWN BY DRAWN_BY	DATE DRAWN_DATE	DRAWING NO. DRAWING_NO	REV REV_NO
JOB INFORMATION			
JOB_REFERENCE			
JOB_ADDRESS			
JOB_CITY_ST_ZIP			

* THE HATCH FLANGE WILL REST ON THE UPPER LANDING FINISHED FLOOR.

CRASH WARNING: TO ENSURE UNOBSTRUCTED OPERATION, NO ITEMS SUCH AS FLOOR OR CEILING TRIM, PICTURES, WINDOW SILL, ETC., SHOULD BE IN THE AREA OF THE ELEVATOR OR HATCH FLANGE. WE RECOMMEND AT LEAST 1" FROM ANY OBSTRUCTION TO THE HATCH FLANGE.

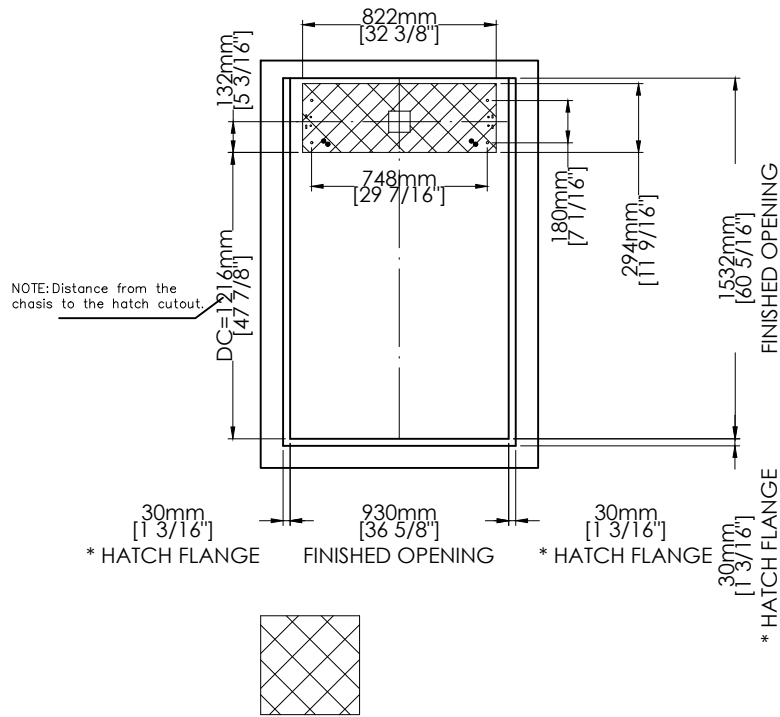

Section force (include rated load): 2904 (lbs)

Section area: 2.58ft²

Force per square foot: 1125 (lbs/ft²)

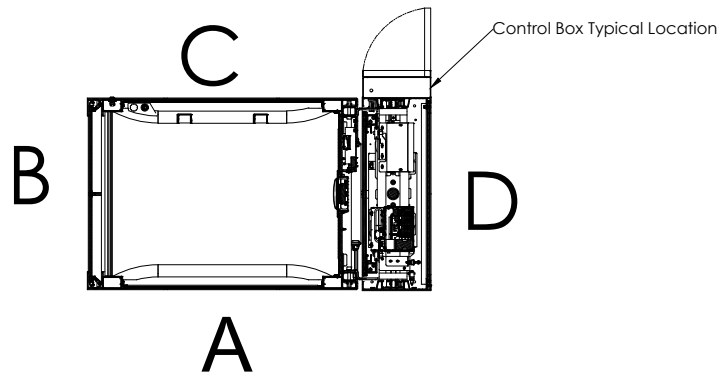

CIBES SYMMETRY

TITLE			SCALE
TFL-L ASCENDA BACKING DETAIL R0			NONE
DRAWN BY	DATE	DRAWING NO.	REV
DRAWN_BY	DRAWN_DATE	DRAWING_NO	REV_NO
JOB INFORMATION			
JOB_REFERENCE			
JOB_ADDRESS			
JOB_CITY_ST_ZIP			

Walls of bricks, terra-cotta, hollow blocks, and similar materials shall not be used for attachment of guide-rail brackets unless they are adequately reinforced. Pull out force 300 lbs

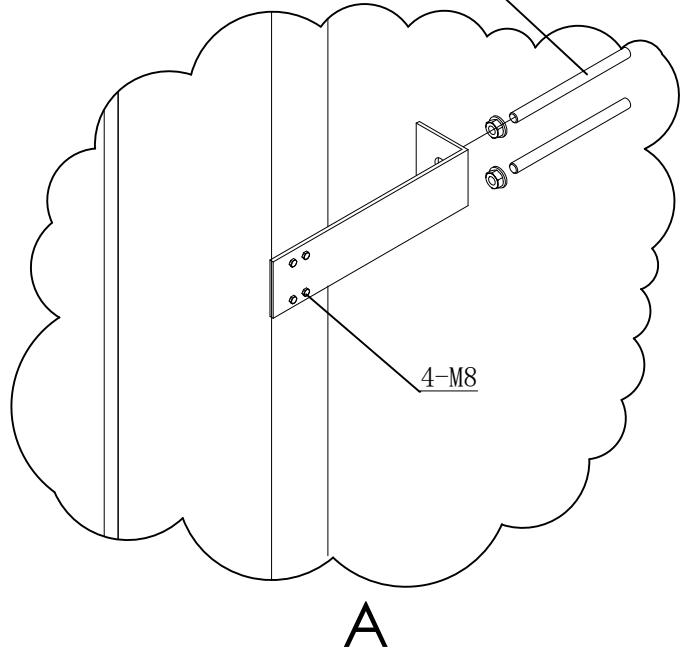
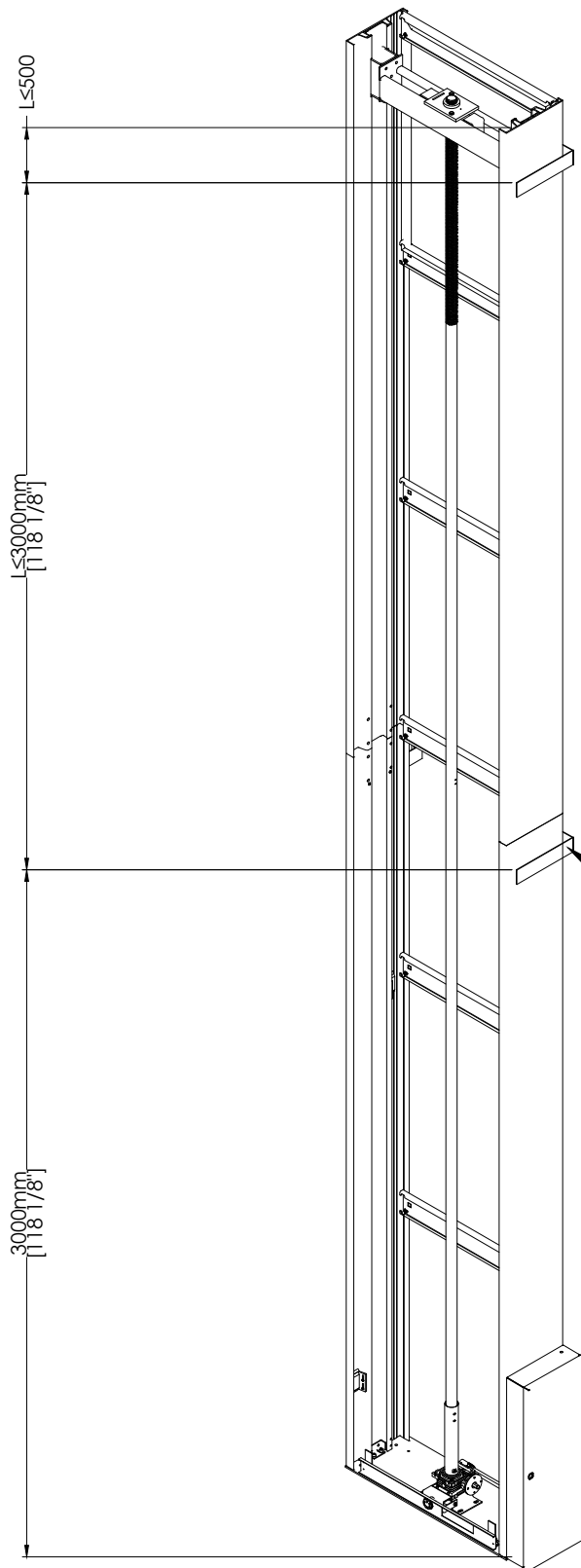

300 lbs in total per side,
600 lbs per fixing area
See detail A

CIBES SYMMETRY

TITLE ASCENDA TFL-L			SCALE NONE
DRAWN BY	DATE	DRAWING NO.	REV
DRAWN_BY	DRAWN_DATE	DRAWING_NO	REV_NO
JOB INFORMATION			
JOB_REFERENCE			
JOB_ADDRESS			
JOB_CITY_ST_ZIP			

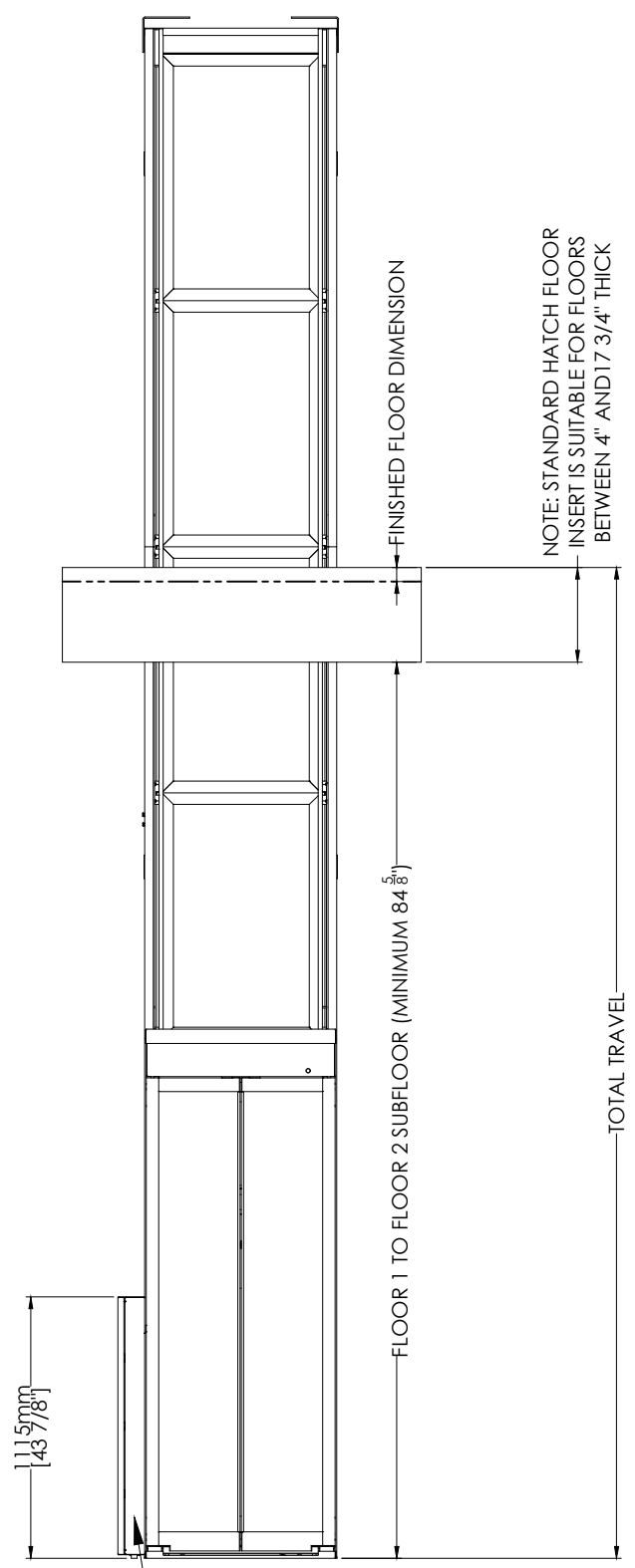

NOTES:

- 1) CONSULT LOCAL AUTHORITY TO ENSURE COMPLIANCE WITH STATE AND LOCAL CODES.
- 2) MAXIMUM TRAVEL IS 14' (168")
- 3) MINIMUM FLOOR 1 TO FLOOR 2 SUB FLOOR MEASUREMENT IS 84 ⁵/₈".
- 4) OVERHEAD NOTES:
 - MINIMUM OVERHEAD IS 7'8" (92") WITH STANDARD EQUIPMENT
 - ENGINEERING REVIEW IS REQUIRED IF OVERHEAD EXCEEDS 100 ¹/₄" AND UNIT WILL ATTACH TO 2x4 WALL STUDS

JOB SPECIFIC INFORMATION:

<input type="text"/>	OVERHEAD
<input type="text"/>	TOTAL TRAVEL FLOOR 1 TO 2

Note: Control box shown on C side.

CIBES SYMMETRY			
TITLE ASCENDA TFL-L			SCALE NONE
DRAWN BY DRAWN_BY	DATE DRAWN_DATE	DRAWING NO. DRAWING_NO	REV REV_NO
JOB INFORMATION			
JOB_REFERENCE			
JOB_ADDRESS			
JOB_CITY_ST_ZIP			

A-A (1:1)

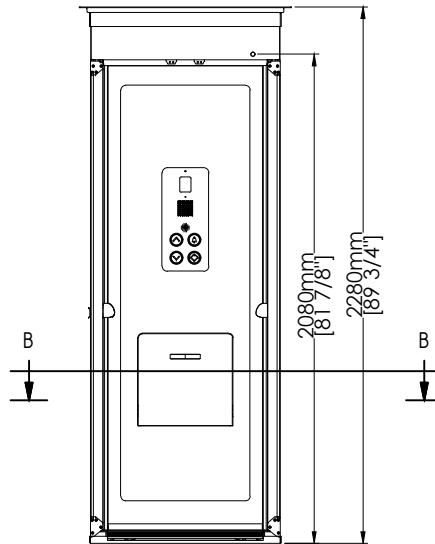
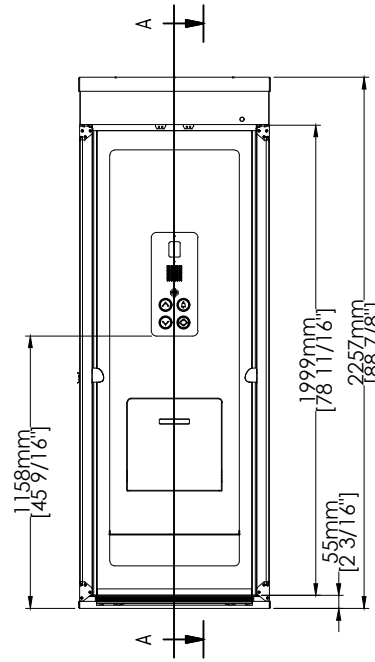
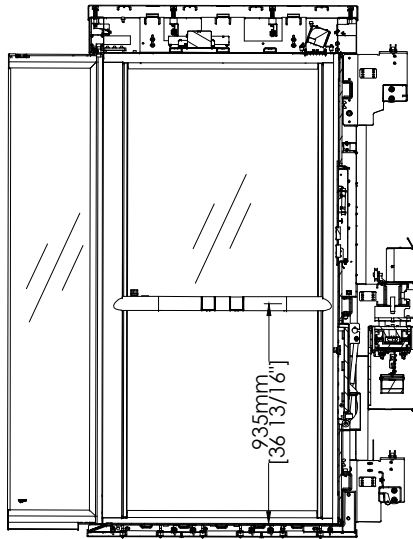

B-B (1:1)

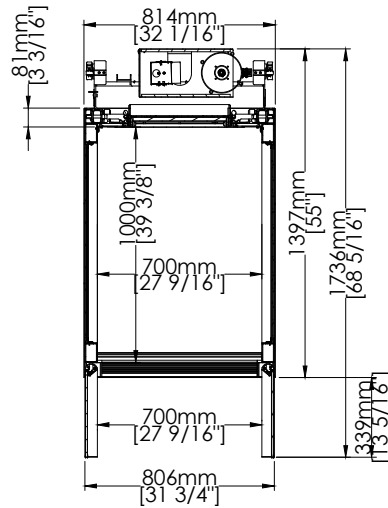

When folded down the seat dimensions are: 400 X 315 (WxD)
Seat maximum load capacity is 150kg

Hatch cover
shown

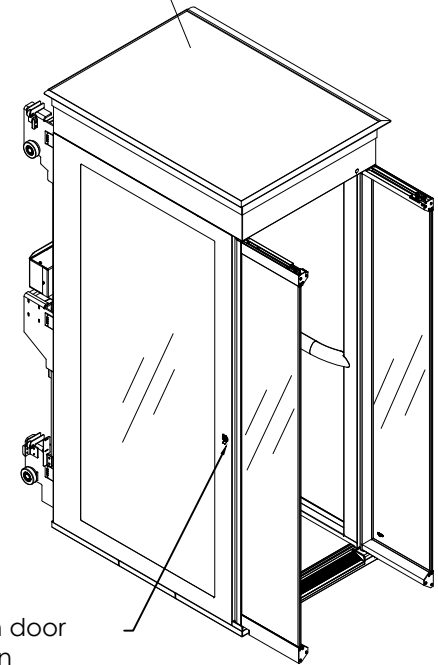

Open door
button

CIBES SYMMETRY			
TITLE ASCENDA TFL-L			SCALE NONE
DRAWN BY DRAWN_BY	DATE DRAWN_DATE	DRAWING NO. DRAWING_NO	REV REV_NO
JOB INFORMATION			
JOB_REFERENCE			
JOB_ADDRESS			
JOB_CITY_ST_ZIP			

OPTIONAL CONTROLLER LOCATIONS

NOTE:
The maximum number bends is two.

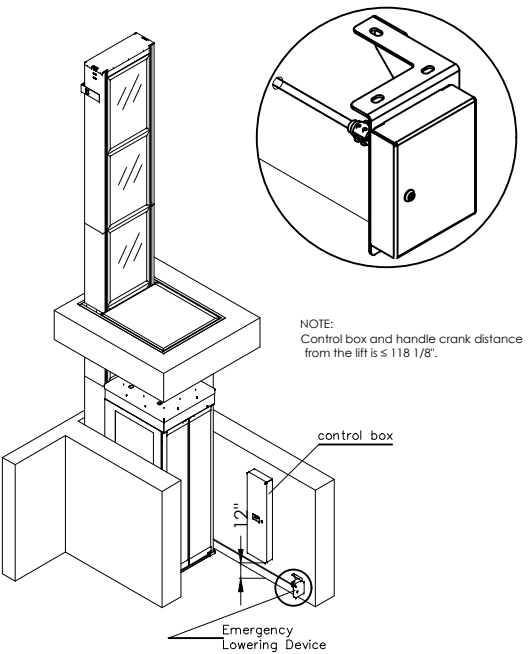
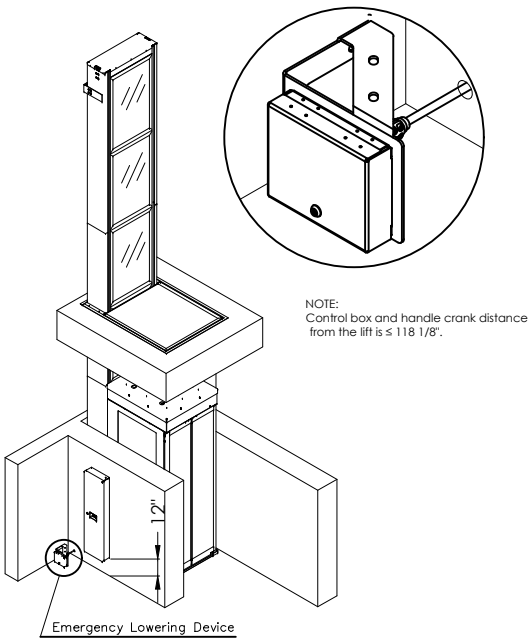
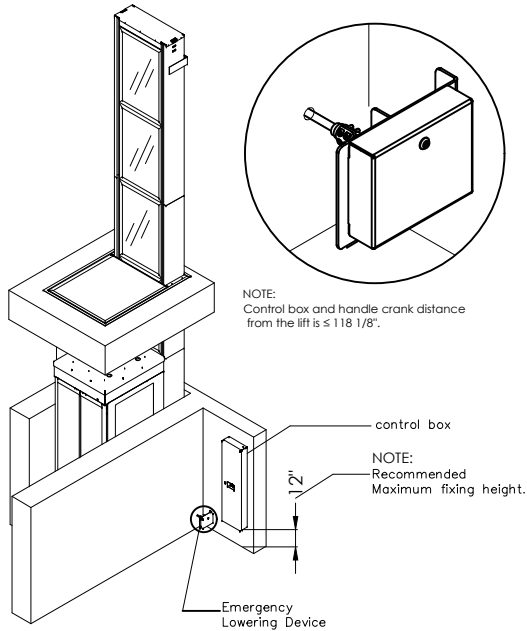
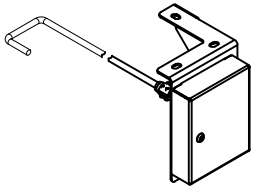

CIBES SYMMETRY			
TITLE ASCENDA TFL-L			SCALE NONE
DRAWN BY DRAWN_BY	DATE DRAWN_DATE	DRAWING NO. DRAWING_NO	REV REV_NO
JOB INFORMATION			
JOB_REFERENCE			
JOB_ADDRESS			
JOB_CITY_ST_ZIP			

Requirement: 92"

B

B

Minimum travel height: 90 1/2"
Maximum travel height: 168"

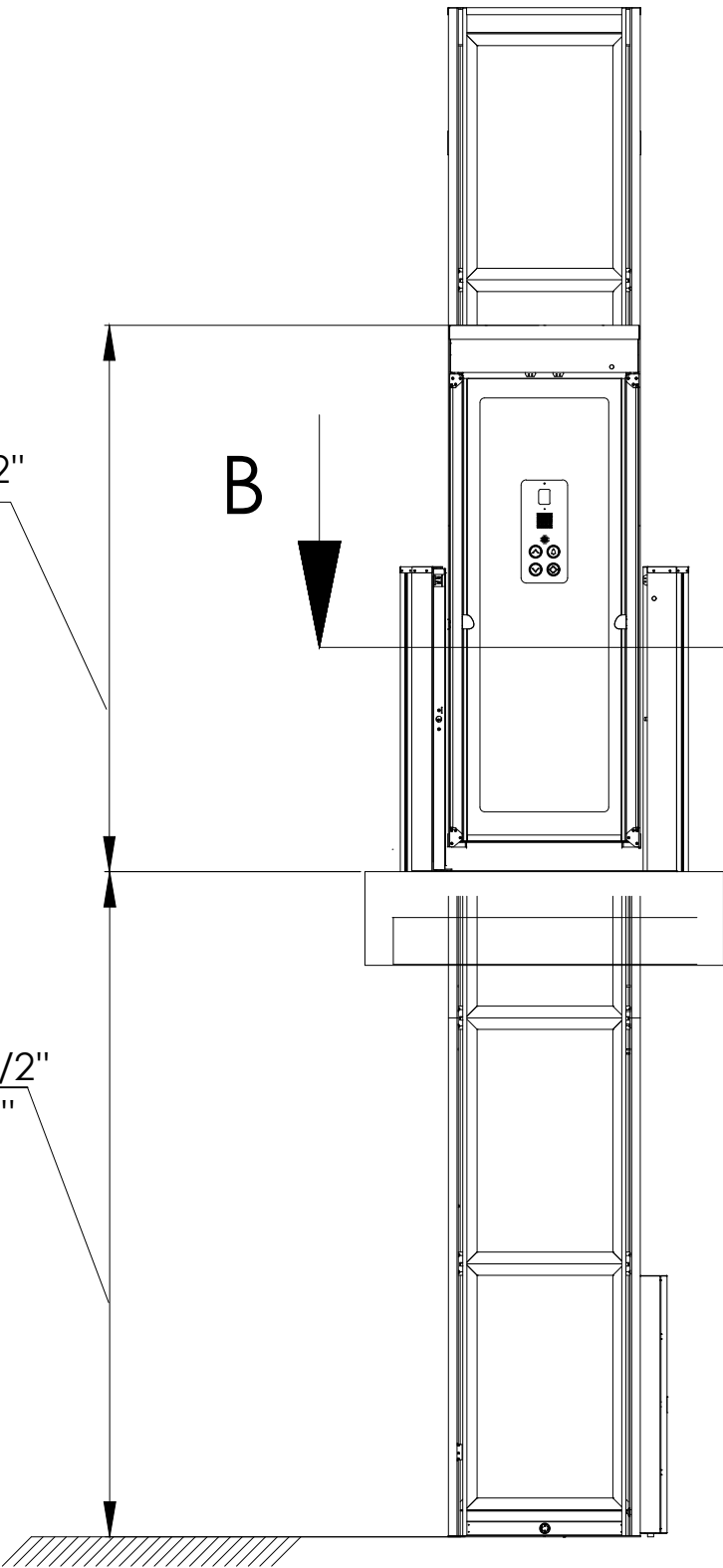

OPTIONAL LANDING GATE

CIBES SYMMETRY			
TITLE ASCENDA TFL-L			SCALE NONE
DRAWN BY DRAWN_BY	DATE DRAWN_DATE	DRAWING NO. DRAWING_NO	REV REV_NO
JOB INFORMATION			
JOB_REFERENCE			
JOB_ADDRESS			
JOB_CITY_ST_ZIP			

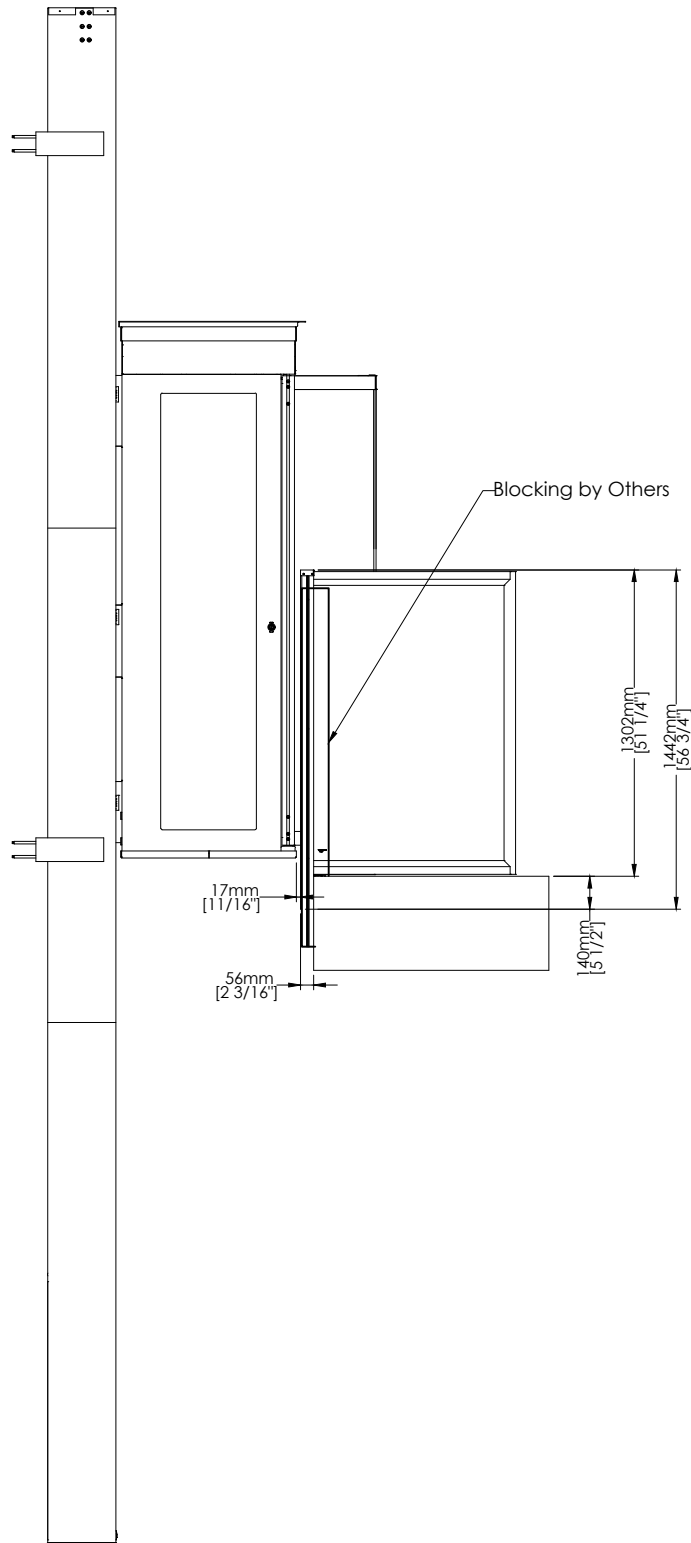

CIBES SYMMETRY			
TITLE ASCENDA TFL-L			SCALE NONE
DRAWN BY DRAWN_BY	DATE DRAWN_DATE	DRAWING NO. DRAWING_NO	REV REV_NO
JOB INFORMATION			
JOB_REFERENCE			
JOB_ADDRESS			
JOB_CITY_ST_ZIP			

Technical drawing of the front view of the device. The drawing shows the device mounted on a wall. Key dimensions and features include:

- Overall width: 1230mm [48 7/16"]
- Overall height: 1549mm [61"]
- Height from wall to top of device: 1499mm [59"]
- Height from wall to bottom of device: 858mm [33 13/16"]
- Width of the central opening: 862mm [33 15/16"]
- Height of the central opening: 17mm [11/16"]
- Height of the top section: 6mm [1/4"]
- Height of the bottom section: 19mm [3/4"]
- Mounting holes are indicated with dimensions 6mm [1/4"] and 19mm [3/4"].
- Labels "Blocking by Others" point to the mounting holes.
- A "WALL" label is at the top right.

Technical drawing of the floor cutsize of the gate. The drawing shows a side view of the gate structure with various dimensions labeled in millimeters (mm) and inches (").

Dimensions shown:

- Overall height: 1493mm [58 13/16"]
- Height from floor to top of gate: 1549mm [61 1/16"]
- Width of gate opening: 1240mm [48 13/16"]
- Width of gate structure: 1230mm [48 7/16"]
- Height of gate structure: 858mm [33 3/16"]
- Height of gate structure (excluding top): 862mm [33 15/16"]
- Height of gate structure (excluding top and bottom): 17mm [1/16"]
- Height of gate structure (excluding top and bottom): 5mm [3/16"]
- Height of gate structure (excluding top and bottom): 19mm [3/4"]
- Height of gate structure (excluding top and bottom): 6mm [1/4"]

Labels:

- Floor cutsize
- Gate Post

Gate support posts are suitable for masonry construction only and should not be used for non-masonry construction.

CIBES SYMMETRY			
TITLE ASCENDA TFL-L			SCALE NONE
DRAWN BY DRAWN_BY	DATE DRAWN_DATE	DRAWING NO. DRAWING_NO	REV REV_NO
JOB INFORMATION			
JOB_REFERENCE			
JOB_ADDRESS			
JOB_CITY_ST_ZIP			